



VICARAGE ROAD
OAKHAM, RUTLAND

JAMES
SELICKS



“... SOUGHT AFTER MARKET TOWN LOCATION ...”

A spacious and well-presented bungalow situated in a sought-after location in the market town of Oakham, offering generous and versatile accommodation throughout.

Kitchen Breakfast Room • Large Reception Room • Cloakroom • Three Bedrooms • Bathroom • Ample Off-Road Parking • Established Private Gardens • Sought After Location • No Onward Chain

Accommodation

The property features a welcoming kitchen diner, ideal for both everyday family living and entertaining, together with a large reception room providing ample space for relaxation and social gatherings.

There are two double bedrooms and a third single bedroom, served by both a family bathroom and an additional WC, offering convenience and flexibility for modern living.

Outside

Outside, the property benefits from ample off-road parking and extensive storage facilities. Set within a private, mature garden, the bungalow enjoys a peaceful and secluded setting with established planting, creating an attractive outdoor space to enjoy throughout the year.

Combining spacious accommodation, practical amenities and a desirable location close to the town's shops, services and local amenities, this is an excellent opportunity for a wide range of buyers.



Location

Oakham is an attractive, historic market town at the heart of Rutland, offering a full range of shops and facilities. The town features excellent primary and secondary schools, with independent schools nearby in Oakham, Stamford, and Uppingham. Conveniently located, Oakham provides easy access to major centres including Leicester, Peterborough, Corby, and Kettering, all with mainline trains to London in under an hour. Surrounded by beautiful countryside and close to Rutland Water, Oakham offers a variety of outdoor activities such as sailing, cycling, fishing, and walking, making it a popular and desirable place to live.

Services & Council Tax

The property is offered to the market with all mains services and gas-fired central heating.

Rutland County Council – Tax Band E

Tenure

Freehold



10 Vicarage Road, Oakham, Rutland LE15 6EG

House Total Approx. Gross Internal Floor Area incl. Garage = 1228 ft² / 114.1 m²

Measurements are approximate, not to scale, for illustrative purposes only.

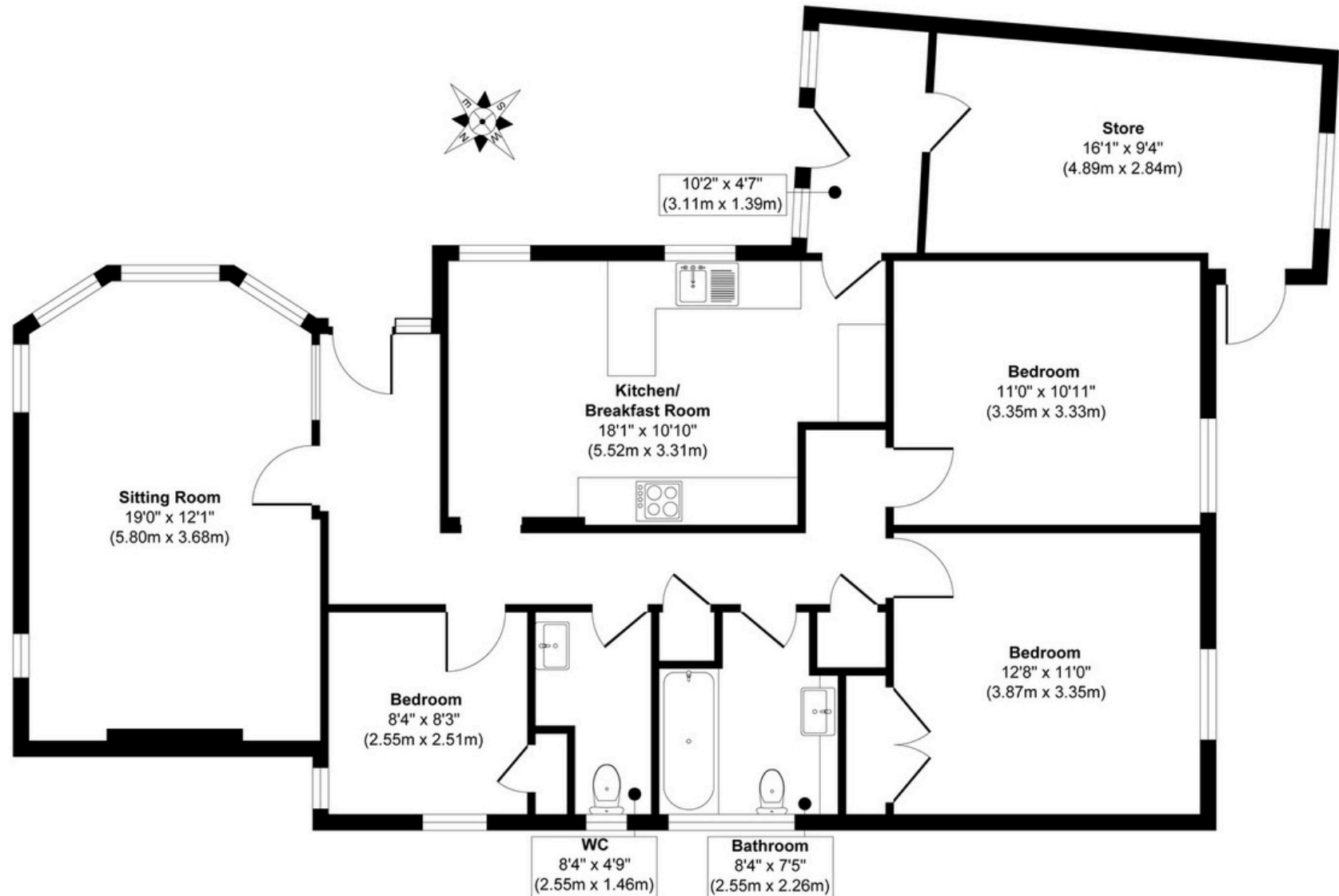

Illustration for identification purposes only, measurements are approximate, not to scale.



JAMES SELICKS

Oakham Office

6-8 Market Place, Oakham
Rutland LE15 6DT

01572 724 437

oakham@jamesselicks.com

Market Harborough Office

01858 410 008

Leicester Office

0116 285 4554

www.jamesselicks.com



Important Notice

James Sellicks for themselves and for the Vendors whose agent they are, give notice that:

- 1) The particulars are intended to give a fair and substantially correct overall description for the guidance of intending purchasers and do not constitute part of an offer or contract. Prospective purchaser(s) and lessees ought to seek their own professional advice.
- 2) All descriptions, dimensions, areas, reference to condition and if necessary, permissions for use and occupation and their details are given in good faith and believed to be correct. Any intending purchaser(s) should not rely on them as statements or representations of fact but must satisfy themselves by inspection or otherwise as to the correctness of each of them.
- 3) No person in the employment of James Sellicks has any authority to make or give any representation or warranty, whether in relation to this property or these particulars, nor to enter any contract relating to the property on behalf of the Vendors.
- 4) No responsibility can be accepted for any expenses incurred by any intending purchaser(s) in inspecting properties that have been sold, let, or withdrawn.

Measurements and Other Information

All measurements are approximate. Whilst we endeavour to make our sales particulars accurate and reliable, if there is any point which is of particular importance to you, please contact this office and we will be pleased to check the information for you, particularly if contemplating travelling some distance to view the property.